



Horion M6APro V2 with Industry-Leading Quad-Camera System



Horion M6APro V2, featuring an industry-leading Quad-Camera System and officially certified by Google EDLA.

With native support for Google Mobile Services (GMS) and the Google Play Store, the M6APro V2 offers unmatched access to productivity tools like Google Meet, Docs, Drive, and more — making collaboration smarter, smoother, and more secure.



Google Play



Core services



Collaboration tools



Super AI quad-camera
wide field of vision



AI speaker mode

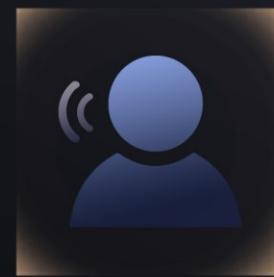

AI intelligent framing



Seamless switching between
long and short focal lengths



Intelligent perception
of scenes



AI Acoustic Engine 3.0



Support Multiple Windows



Extremely smooth experience



AI Quad-Camera Broadens the Field of Vision — See More, Do More

Adopting the master lens group, it is equipped with a brand-new optical structure design of an AI ultra-wide-angle main camera and a telephoto close-up triple camera, integrating multi-lens capabilities. Through the new AI super-resolution algorithm and self-developed VCS human eye bionic technology, it brings a comprehensive improvement in "form, quality, light, color and picture".

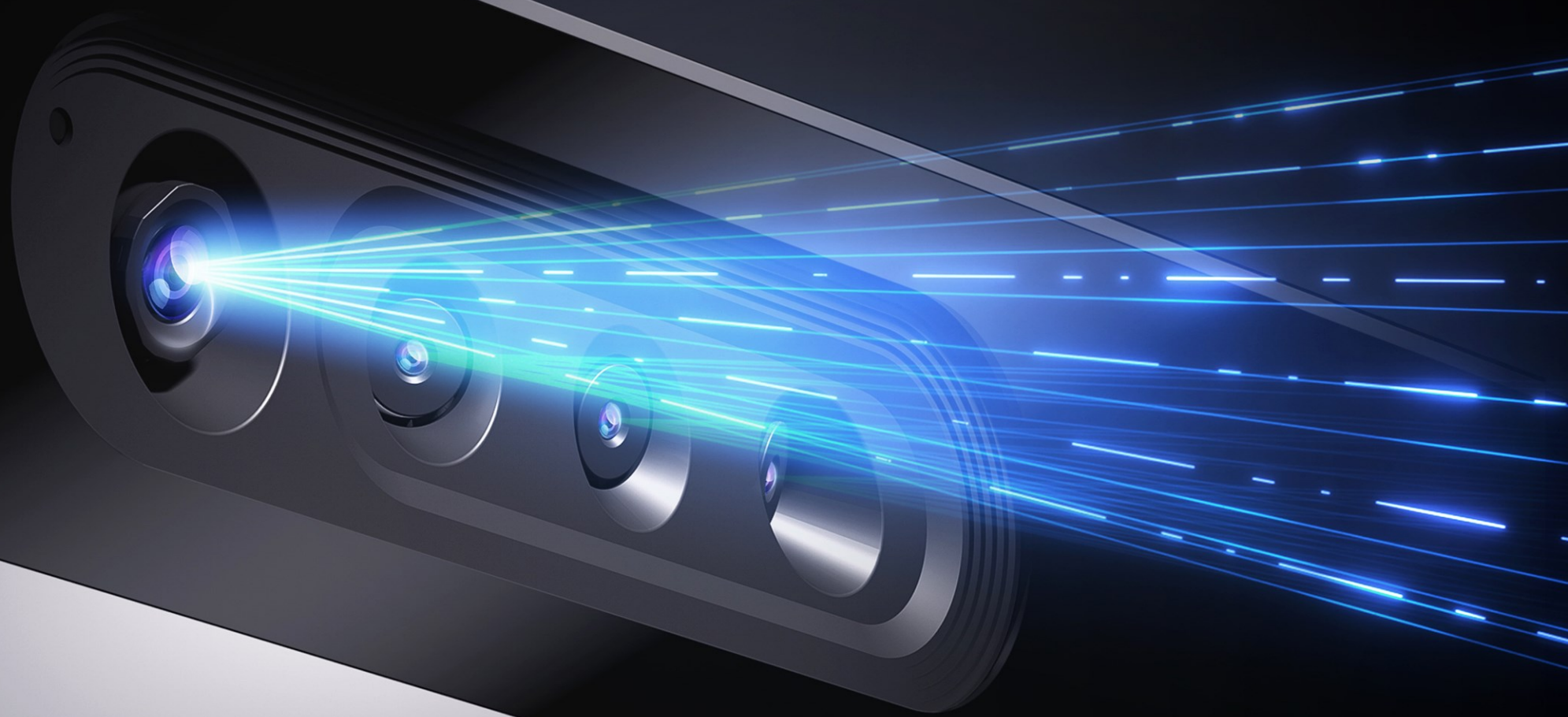

72 million AI ultra-sensitive camera

- SONY 1/2-inch large sensor
- 110° ultra-wide viewing Angle
- AF auto focus
- Outstanding low-light performance

4K telephoto Close-up triple shot

- Advanced BSI process
- Multi-lens capability integration
- The entire conference is covered by telephoto lenses



Multi-focal length 4K view Both near and far are clear

From panoramic views to detailed close-ups, the focal length switches seamlessly. Framing and composition are effortless. No matter how far away, close-ups of people can be clearly captured. The meeting discussion is immersive and focused.

110°

Panoramic view



Close-up of the character



AI intelligent framing

The best perspective switches seamlessly

The intelligent framing function, through the built-in AI computing power and high-speed processor chip, combined with face detection algorithms, can automatically adjust the picture size according to the number of participants and changes in their positions. The picture switching is fast, accurate and stable, presenting the best framing.



Presenter mode

Intelligently lock in the golden position

The ultra-high-precision sound source location and face detection algorithm lock in the center position. Combined with the triple-camera telephoto lens, it ensures that close-ups of the speaker at near and far are clearly presented. Hearing their voices and seeing their faces, remote communication is like being face to face.



AI Acoustic Engine 3.0

12-meter uniform sound pickup

- 8 array microphones working in coordination
- 12M uniform pickup
- Over 300 common noise filters

Equipped with the intelligent 3A algorithm, it eliminates over 300 common noises and echoes in meeting rooms. Combined with the distance detection technology for people, it restores the true sound color at different distances and automatically enhances it. No matter how far or near the position is, everyone's voice is clear and powerful.



A groundbreaking masterpiece Make a resounding entrance

40W high-fidelity speaker | 20W subwoofer

It adopts independent high, medium and low audio units. The 20W*2 speakers and 20W subwoofer each perform their own duties and work in coordination to deliver a stunning sound effect with a wide high-frequency range, high balance, high dynamics and high fidelity, providing an immersive audio-visual experience with outstanding sound quality.



8-core flagship processor

Outstanding performance and soaring efficiency

AI performance plus 135% powerful image intelligence application

The encryption engine ensures information security

Equipped with an 8-core flagship processor, it offers powerful performance. With an inbuilt AI accelerator, its performance soars continuously. Even after long periods of operation, it remains as smooth as ever.

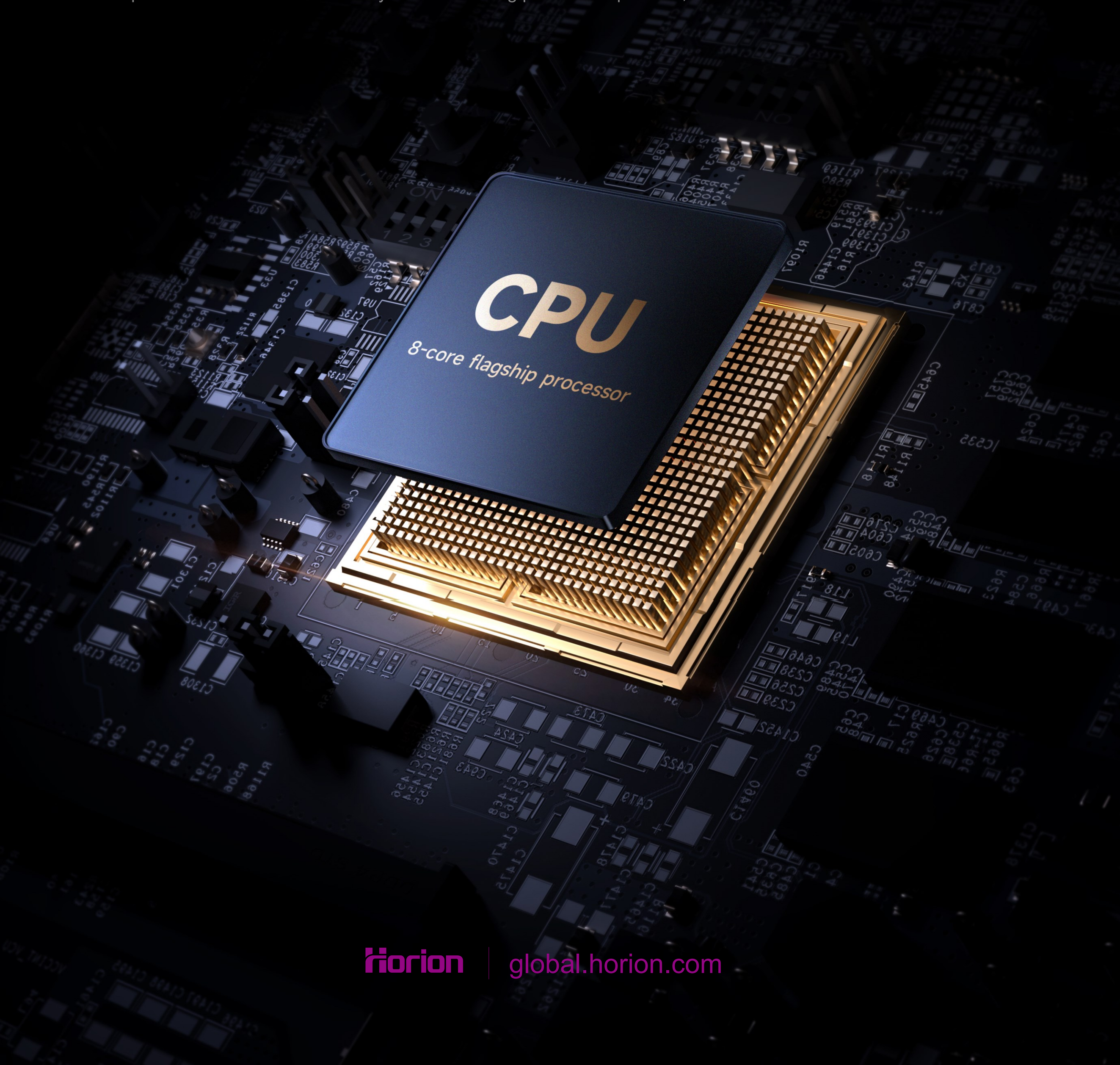

16GB+256GB super large storage

LPDDR4X ultra-high-speed data transmission

Meeting users' demands for large memory and high-speed storage, meeting files can be opened instantly, easily handling various high-intensity tasks and applications, and running smoothly in all scenarios.

16G

High-end DDR4X

256G

High-speed flash memory

Dual-power dedicated power supply Superconducting materials, highly efficient and safe

Reject overload and overheating | High stability | high reliability

The wide voltage design covers the global voltage range. At the same time, it adopts a dual-power dedicated power supply, ensuring efficient power transmission and the safe and stable operation of the two systems.

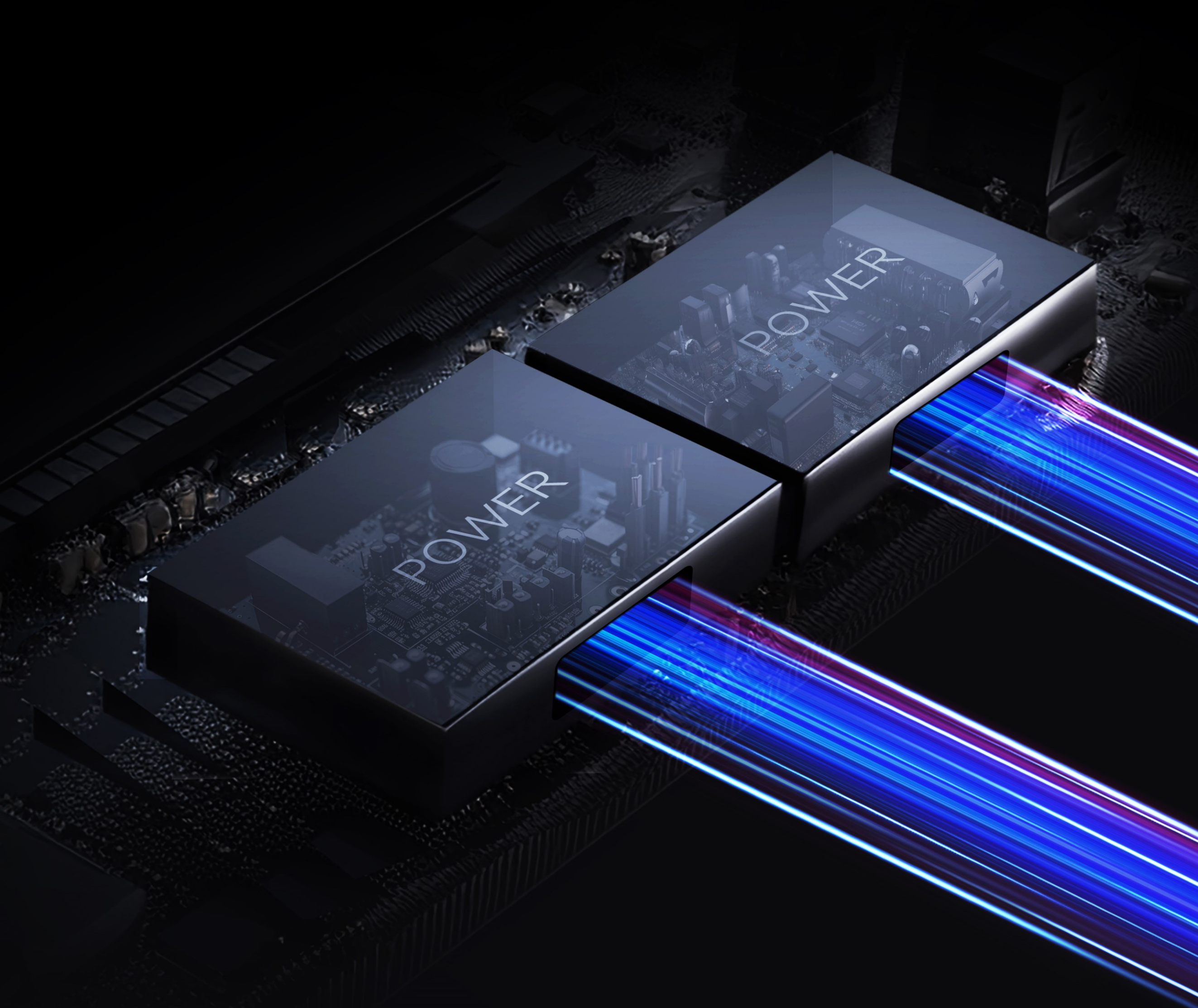

Extremely smooth writing experience Where inspiration strikes, wisdom flows freely

The Horion smooth writing experience is optimized based on the writing habits of over a million people worldwide. The handwriting is precise to the minuscule detail, with an almost imperceptible delay when putting pen to paper. It is smooth and responsive, as smooth as silk, and simply wonderful.

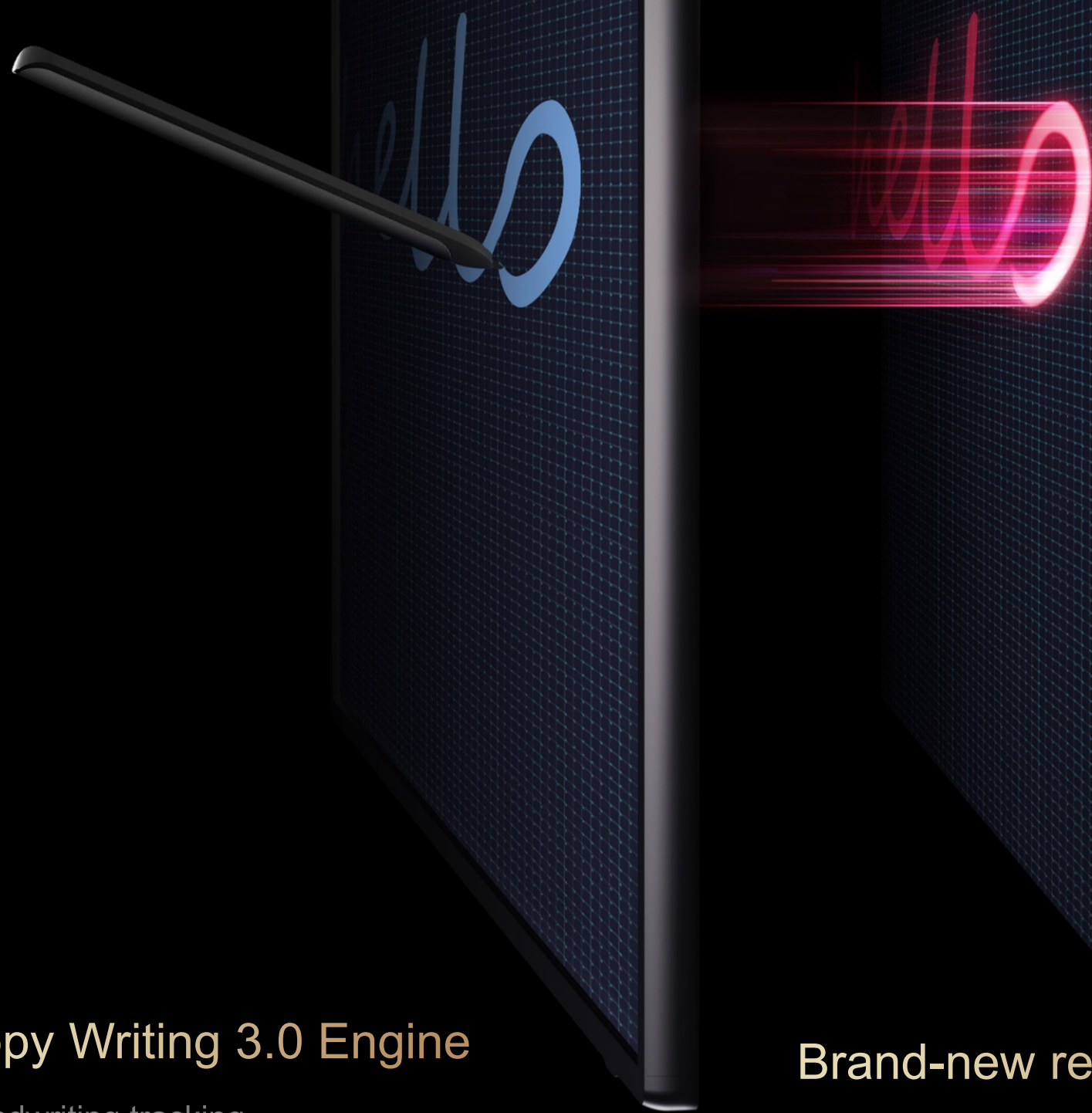

Happy Writing 3.0 Engine

AI handwriting tracking

Brand-new realistic canvas

Co-creation by multiple people knows no boundaries

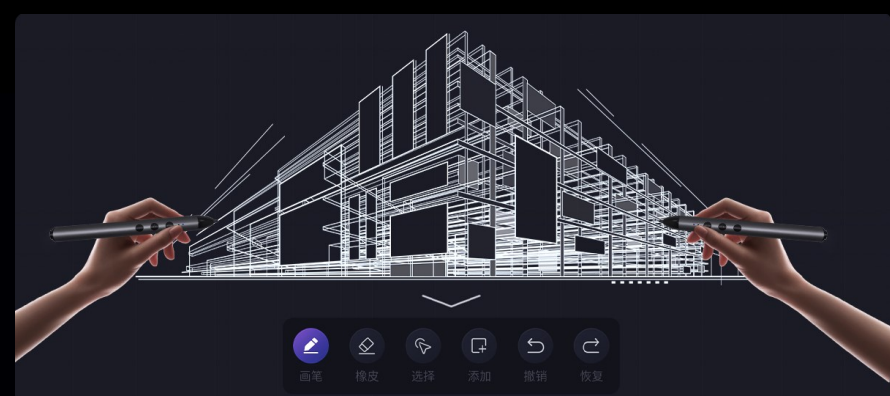

The entire process of the meeting Now, with the support of AI

- AI voice intelligent response
- AI Mind map
- AI selects all images for recognition
- AI-generated paintings/raw images
- Real-time subtitles
- AI translation/reading aloud

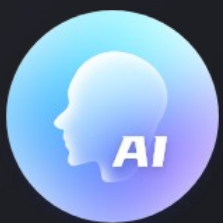

Multifunctional Smart Whiteboard

The Horion's smart whiteboard is self-developed with rich functions, supporting the insertion of tables, documents, slides, pictures, videos and other files. It allows for annotation while presenting, making the review process more convenient.

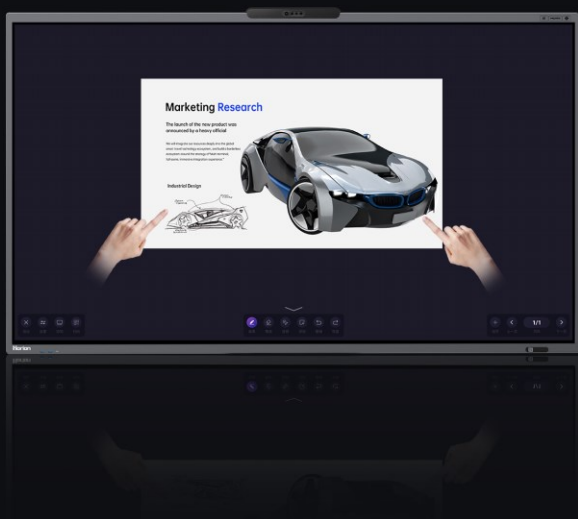

Smart and quick gesture

One-point to write, two-point to zoom, three-point to drag

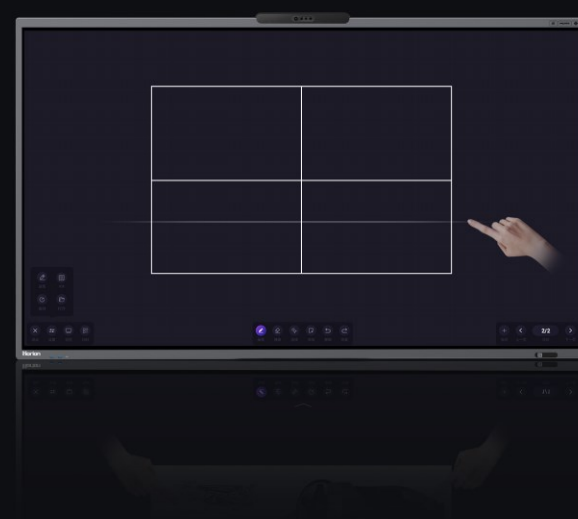

Smart Table

Allows users to easily insert, add, or delete rows and columns directly within the smart whiteboard.



Write immediately upon picking up the pen

Automatically bring up the whiteboard and make annotations



Automatically bring up the whiteboard for annotation

The whiteboard and the annotated content can be taken away by scanning the code

Remote whiteboard collaboration

Cross-screen collaboration and efficient discussion

AI performance increases by 135% Powerful image intelligence application
Encryption engine Ensure information security

The wide voltage design covers the global voltage range. At the same time, it adopts a dual-power dedicated power supply, ensuring efficient power transmission and the safe and stable operation of the two systems.



From small screens to large screens All kinds of devices are compatible

Mainstream devices

Android, IOS, MacOS, Windows

All-new self-developed

K-share, DLNA, Airplay and Miracast with super full protocol

Supports wireless screen projection from multiple devices such as mobile phones and computers. You can make presentations, view charts, and discuss solutions. It's easy to project from a small screen to a large one. Everyone can find a screen projection method that suits them.

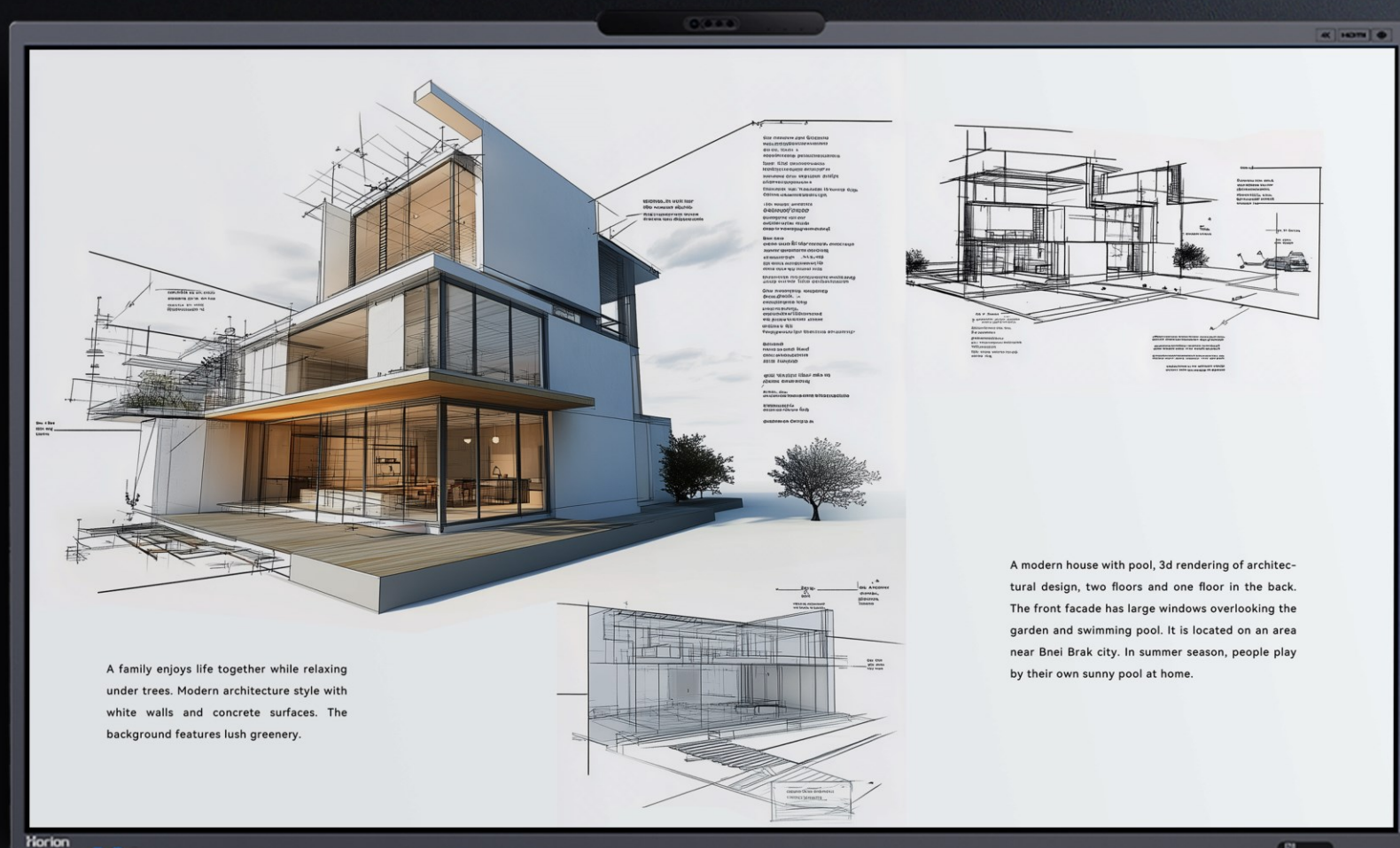



9 split-screen display

Multi-person meeting discussion,
Split-screen comparison review



NFC one-touch screen projection

For mobile phones with NFC functionality,
simply approach the NFC sensing area to
achieve one-touch screen projection

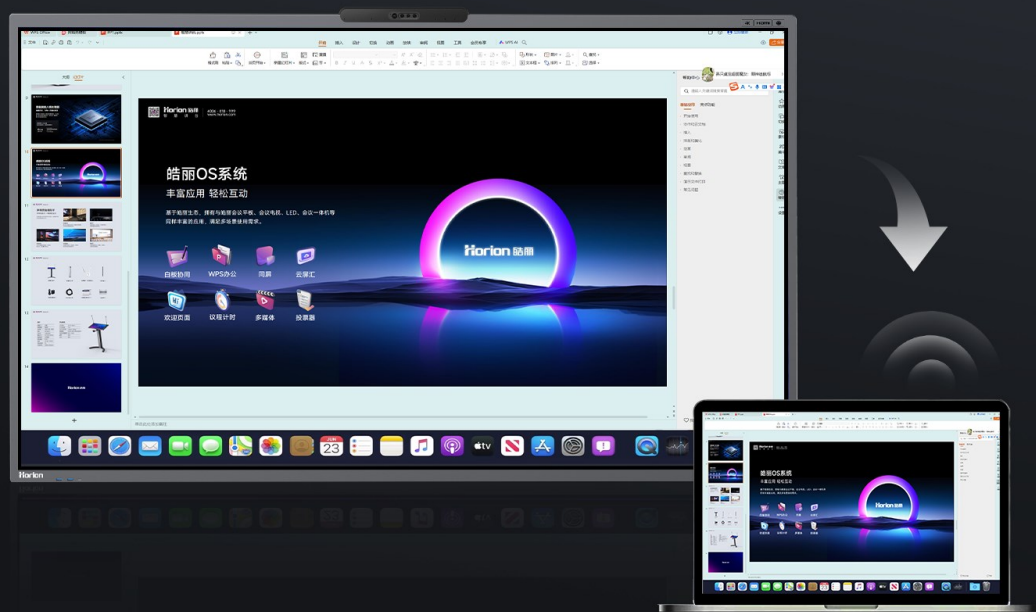

Reverse touch

No need to operate a computer, the main
speaker of the conference page turning
and annotation can be directly controlled
on the meeting tablet

Dual-band dual-Wi-Fi

Fast, accurate and stable screen projection

The brand-new upgraded dual WiFi module features dual WiFi channels, supporting independent WiFi screen projection. It also supports both 2.4G and 5G dual frequency bands. You can project your screen while surfing the Internet, ensuring fast and stable network access.

240%↑

Improved transmission speed

4times↑

Improved clarity

105%↑

Improved stability

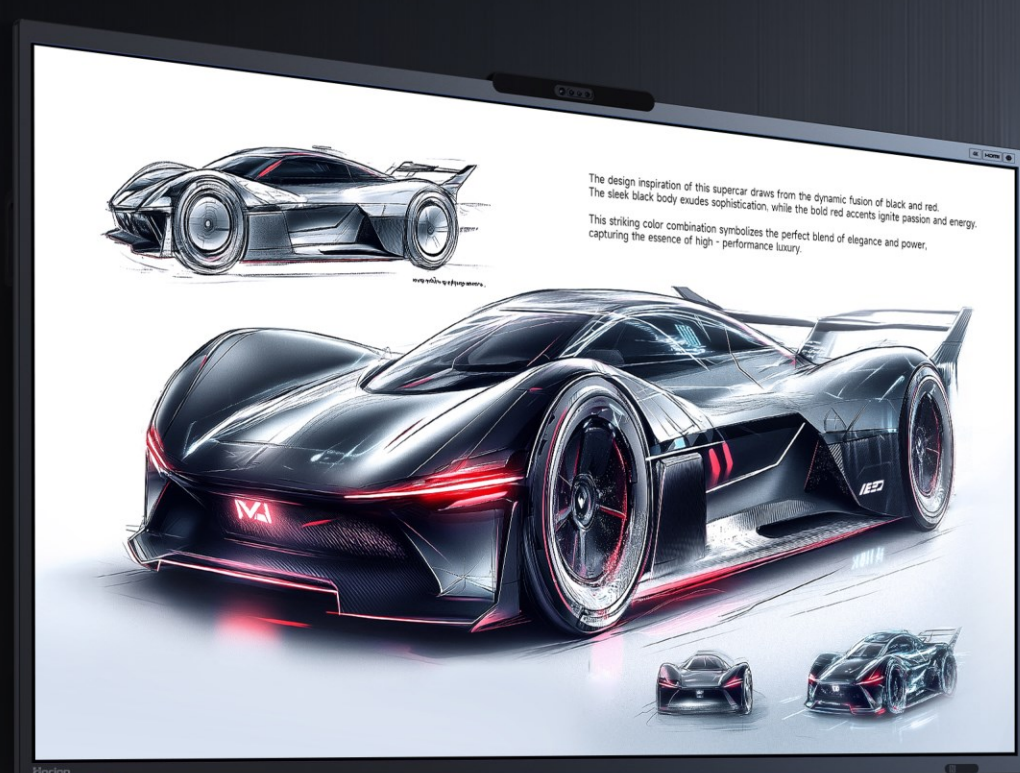

Screen group

Multi-screen synchronization in the conference venue

It can achieve the function of projecting multiple large screens from one device, supporting up to 128 screen groups, easily handling all kinds of large-scale meetings



BYOM video conference

The computer opens up a large screen view

Start the video conferencing software on a personal computer. While maintaining the original usage habits, you can directly use the professional audio and video capabilities of the conference tablet to easily obtain a professional video conferencing experience.



Start the BYOM video conference

Supports Multiple Windows

Full-screen multi-opening doubles efficiency

Multiple applications are displayed on the same screen, and the window size can be flexibly adjusted to quickly handle multiple tasks. When teams collaborate and discuss, there is no need to switch applications. Review while recording on the whiteboard, and work can be carried out efficiently.



Outstanding Experience

And there is also an outstanding level of appearance

Based on your needs, see which meeting tablet is suitable for you



Rounded corners and
ultra-narrow bezels



National patent design base



Aluminum alloy metal body



Humanized storage tray

Dimensions and parameters

The business aesthetic appearance offers an outstanding meeting experience, with exquisite workmanship and extraordinary craftsmanship



Dimensions	65"/75"/86"	System version	Android 14.0
Resolution	3840*2160	Color Gamut(x% NTSC)	85%NTSC
Contrast ratio	1200： 1	CPU architecture	Cortex A73+A53
Chromaticity	1.07B(10bit)	Audio Output Power	20W ×2
Pixel	48MP+3*8MP	RAM+ROM	16GB+256GB
Response time	8ms	Pick up Area	12m(Angle: 180°)
FOV	FOV（main camera） H99.7°， V67.4°， D107.9°+3° FOV（secondary camera） H105°， V43°+3°	WiFi+ Bluetooth	WiFi6+WiFi5, Bluetooth 5.3
Lifespan	50,000 hrs	Sensor	Infrared, NFC, and light sensor
Size	65" bare machine :Product Size(W×D×H) 1512mm × 87mm × 909mm,Net Weight:39.5kg±1.5kg 75" bare machine: Product Size(W×D×H) 1723mm × 88mm × 1022mm,Net Weight:53.2kg±1.5kg 86 "bare machine :Product Size(W×D×H) 1968mm × 88mm × 1160mm,Net Weight:68.1kg±1.5kg		

horion